

Vacuum Ejectors (with back blow function)



Vacuum Ejectors MSV

Suction capacity: 86 L/min to 168 L/min

Vacuum Ejectors MSV



Introduction and application

- ◆ 3-stage vacuum tube, XI vacuum tube provides high vacuum
- ◆ Suitable for adsorption and self-adhesive products

System Design Vacuum Ejectors MSV

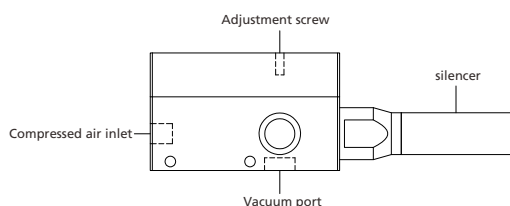

Design

- ◆ Body made of aluminum
- ◆ The seal is made of NBR rubber
- ◆ With back blow function
- ◆ With back blow flow adjustment function

Ordering Guide Vacuum Ejectors MSV

Type	Ordering Data
MSV10	90.05.01.00209
MSV25	90.05.01.00210

Technical Data Vacuum Ejectors MSV

Type	Maximum vacuum [%]	Maximum suction force [l/min]	Air consumption [l/min]	Operating pressure [bar]	weight [g]	Operating temperature [°C]
MSV10	88	86	36	5	350	-10...80
MSV25	91	168	120	5	490	-10...80

Combined Suction Cups

Vacuum Suction Cups

Composite Suction Cups

Special Grippers

Vacuum Gripping Systems

Mounting Elements

Vacuum Generators

Valve Technology

Switch And Monitoring

Vacuum Filters

Vacuum Ejectors (with back blow function)



Vacuum Ejectors MSV

Suction capacity: 86 L/min to 168 L/min



Design Data Vacuum Ejectors MSV

MSV

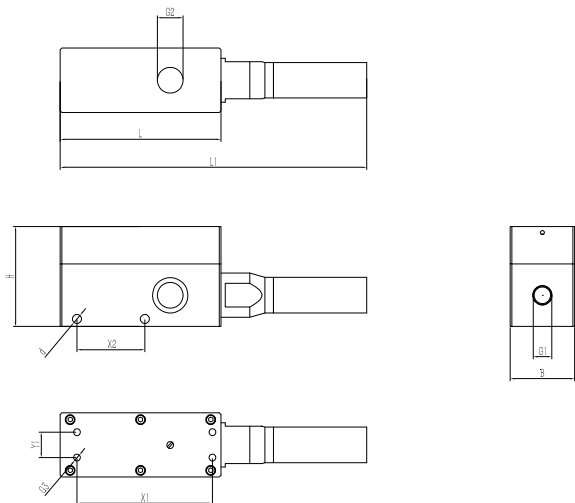

Type	Dimensions [mm]										
	B	d	G1	G2	G3	H	L	L1	X1	X2	Y1
MSV10	30	5.5	G1/8"-F	G1/4"-F	M4-F	44	72	129	57	28	10
MSV25	38	5.5	G1/4"-F	G3/8"-F	M5-F	59	95	181	80	40	15



Performance curve Vacuum Ejectors MSV

Vacuum flow corresponding to different vacuum degrees at 5 bar working pressure

Vacuum flow corresponding to different vacuum degrees at 5 bar working pressure

